

# 1CC - 02

## TECHNICAL DATA

- **Max working pressure:** 250 bar (350 bar)
- **Materials:** Aluminium Body (Steel body if required)

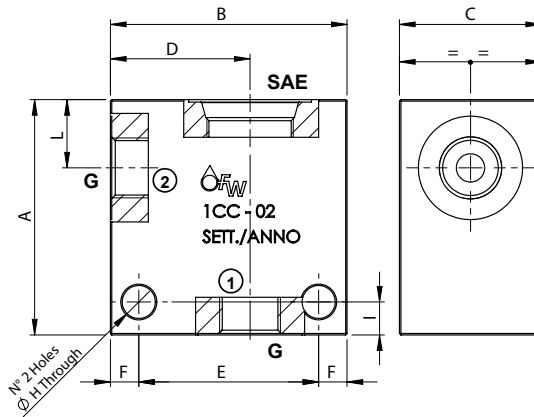

DIMENSIONS											Code Cavity SAE
SAE	G	A	B	C	D	E	F	H	I	L	
08	1/4	50	50	30	30	38	6	7	7	14,5	FW3402000
	3/8										
10	3/8	56	60	35	35	48	6	7	7	18,5	FW7802000
	1/2										
12	3/4	70	70	40	40	54	8	9	8	26,5	FW1160200
	1"	80	80	50	46	60	10	8,5	8	26,5	

## ORDERING CODE

1CC

02

### Cavities:

- 08 = SAE 08
- 10 = SAE 10
- 12 = SAE 12

### Ports Size:

- 1/4 - 3/8
- 3/8 - 1/2
- 3/4 - 1"

### Material Body:

- 0 = Aluminium
- 1 = Steel